

ENGINEERING STANDARDS SECTION

GENERAL MOTORS CORPORATION - G. M. TECHNICAL CENTER - WARREN, MICHIGAN

$$T_1 \text{ MINUS } T_2 = .0090 - .0045$$

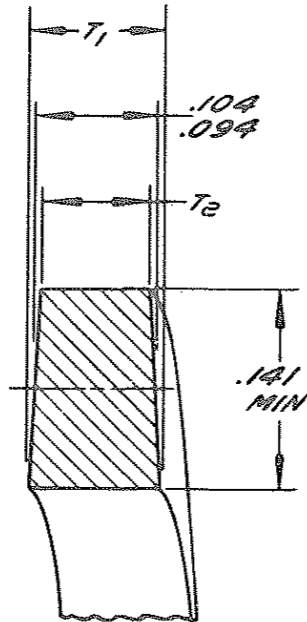

ENLARGED SECTION

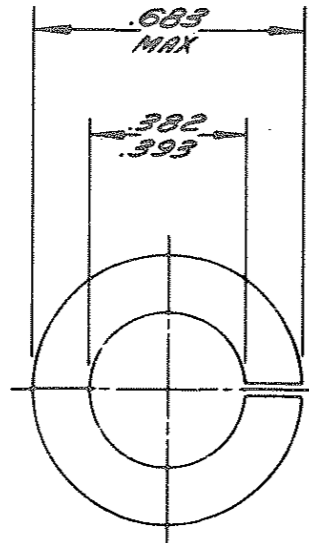

GAP AND RELATIONSHIP OF ENDS
TO BE SUCH AS TO PREVENT
WASHERS TANGLING AND INSURE
THAT WASHERS WILL COMPRESS
FLAT

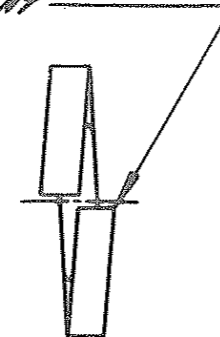

NOTE:

UNSPECIFIED DETAIL WITH RESPECT TO DIMENSIONS, MATERIAL METHODS OF TEST, ETC., MUST CONFORM TO GENERAL SPECIFICATIONS PUBLISHED IN G. M. ENGINEERING STANDARDS. TOLERANCE PLUS OR MINUS .010 UNLESS OTHERWISE SPECIFIED.

DWG. DATE	5-11-26	SCALE	DR. MD
REFERENCE			CK. <i>MD</i>
		APPR.	
MATERIAL SPEC.			
STEEL - SEE NOTE ROCKWELL C45-53			
NAME			
WASHER - REGULAR HELICAL SPRING LOCK			
DESCRIPTION		PART NO.	
FINISH		103321	

Ver No	Sira No
1718/15	

DESCRIPTION	PLAIN
FINISH	