

ENGINEERING STANDARDS SECTION

GENERAL MOTORS CORPORATION - G. M. TECHNICAL CENTER - WARREN, MICHIGAN

$$T_1 \text{ MINUS } T_2 = .0070 - .0035$$

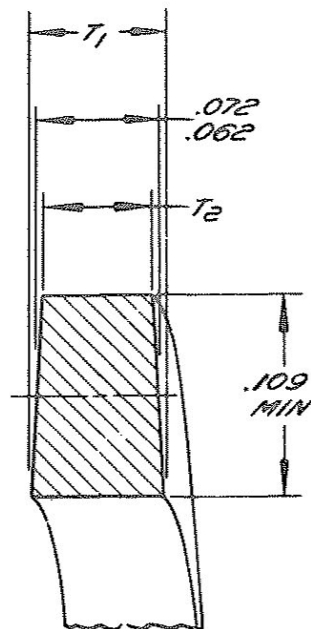

ENLARGED SECTION

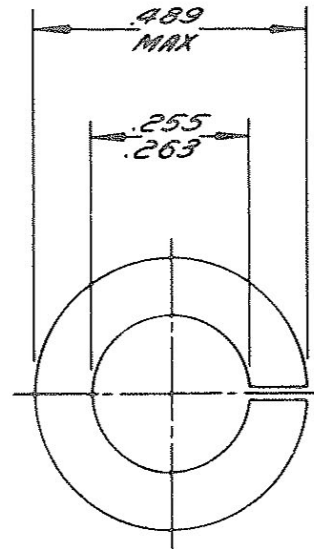

GAP AND RELATIONSHIP OF ENDS
TO BE SUCH AS TO PREVENT
WASHERS TANGLING AND INSURE
THAT WASHERS WILL COMPRESS
FLAT

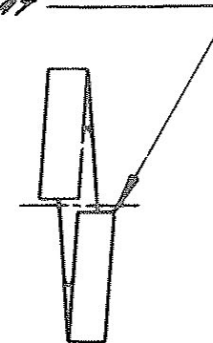

Ver No	Sira No
1718	140

NOTE:
UNSPECIFIED DETAIL WITH RESPECT TO DIMENSIONS MATERIAL
METHODS OF TEST, ETC. MUST CONFORM TO GENERAL SPECIFICATIONS
PUBLISHED IN GM ENGINEERING STANDARDS.
TOLERANCE PLUS OR MINUS .010 UNLESS OTHERWISE SPECIFIED

DWG. DATE 12-19-44	SCALE	DR. FN
REFERENCE PLAIN N° 103319	CK. FN	APPR.
MATERIAL SPEC. STEEL - SEE NOTE ROCKWELL C45-53		
NAME WASHER - REGULAR HELICAL SPRING LOCK		
PART NO. 120380		

DESCRIPTION $\frac{1}{4}$ (.250)
FINISH ZINC GM 4342-M (CODE 15)