

8162329

PERMISSIBLE VARIATION ON COMMON
FRACTION DIMENSIONS TO MACHINED SURFACES
TO BE $\pm .010$ UNLESS OTHERWISE SPECIFIED.

BREAK ALL SHARP CORNERS
UNLESS OTHERWISE SPECIFIED.

COUNTERSINK ALL TAPPED
HOLES 118° X ONE THRD DEEP

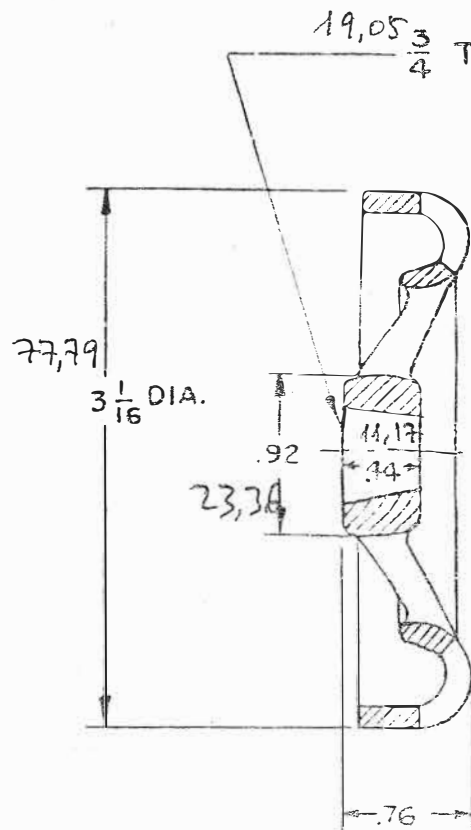

SECTION A-A

19.05 $\frac{3}{4}$ TOTAL TAPER PER FT.

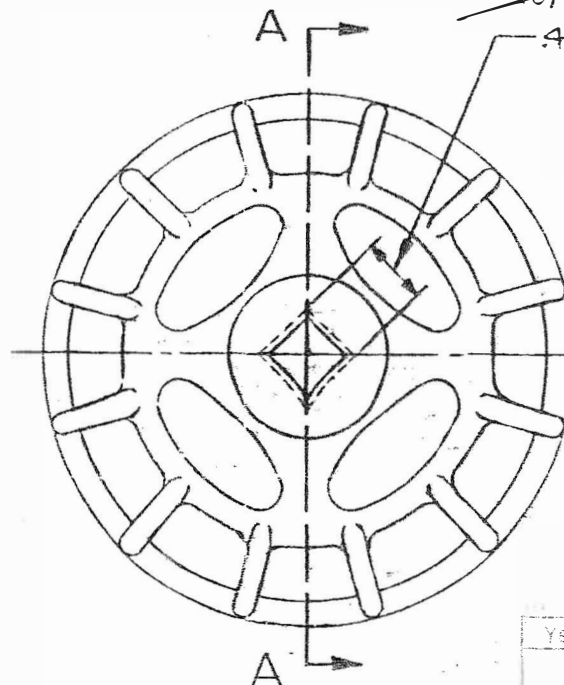

10.16 7.16
40 SQ. AT LARGE END.

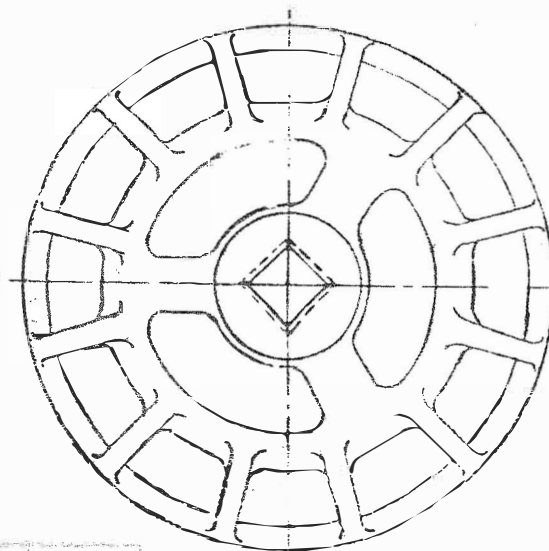

OPTIONAL

Yer No. 1 Sira No.
4030

MAY BE MADE FROM MALLEABLE IRON
OR DIE CAST ALUMINUM (OPTIONAL).

REV.	REVISION	DATE	BY	CK.	APVD.
B	DIF 185. 20.12.2018				
	MAT'L ADDED.				
	SECTION A-A ADDED.				
	OPTIONAL VIEW ADDED.				
Q-5171	A	REDESIGNED. VEND. REV'D 5-10-54			
		FIRST USED ON SW-8			

NO. REQ'D PER ASSEMBLY

MATERIAL
SEE NOTE

NAME OF PART

PART NO.

IT
NO.

ELECTRO-MOTIVE DIVISION
GENERAL MOTORS CORPORATION
LA GRANGE, ILLINOIS, U.S.A.

WHEEL - VALVE

DATE OF PRINT

PART NO.

8162329

DR. H. Becker 8-29-50
7. D. H. 9-6-50
CH. CR.
CH. DR. H. D. 9-6-50
ENGR.