

PART NO.

8333178

F DİF.2389'a Dış 3/4-10 UNC oldu 30.04.2007.

RFC NO.

REV

LET

REVISION

DATE

BY

APVD

UGCONV

CI

REDRAWN IN UG TO LATEST DFTG STDS,
REV "A" & "B" REMD, WAS "A" SIZE.

01JAO0 BPR

D66524

DI

VIEW A ADDED.

05DE03 LDD 04/01/07

E DİF.2243'e göre dış M20 oldu 02.03.2006

3/4-10 UNC-2A THD

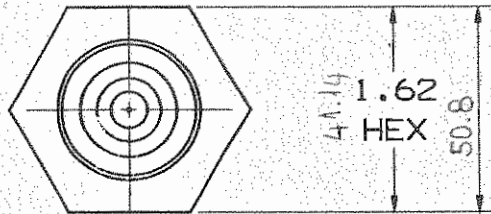
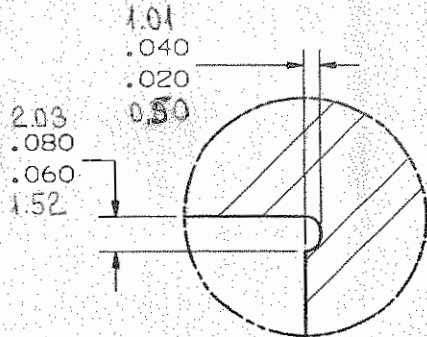
OPTIONAL LATHE CENTER
EACH ENDOPTIONAL HEX 2.00 $+0.05$
 -0.00 VIEW A
OPTIONAL UNDERCUT IN HEAD

Serilili: 54-58 HRC

Serilik derinliği: 2,5 - 3 mm (50 HRC)

Malzeme: 4140

TOLERANCES ON ALL DIMENSIONS NOT SPECIFIED ON THE DRAWING TO BE IN
ACCORDANCE WITH A.S.F. 2400. BREAK ALL SHARP CORNERS UNLESS OTHERWISE
SPECIFIED. ALL DIMENSIONS ARE IN INCHES UNLESS OTHERWISE SPECIFIEDAPERTURE
CARD ONLY

MATERIAL

EMS 86 STEEL PIN

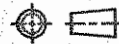
ELECTROMOTIVE
LA GRANGE, IL. 60525, U.S.A.
LONDON, ONT. N6A 4N5, CANADATHIRD ANGLE
PROJECTIONCOMPUTER GRAPHICS
CHANGE ONLYAPPROXIMATE
WEIGHT (LBS)

1.46

UNLESS OTHERWISE SPECIFIED: THIS DOCUMENT IS IN ACCORDANCE WITH
ASME Y14.5M - 1994 AS AMENDED BY THE GM GLOBAL DIMENSIONING AND
TOLERANCING ADDENDUM - 2001. ALL GEOMETRIC TOLERANCES AND RELATED
DATUMS APPLY RFS. RULE #1 (PERFECT FORM AT MMC) DOES NOT APPLY WHEN
A RELATIONSHIP BETWEEN FEATURES IS ESTABLISHED BY ORIENTATION OR
LOCATION TOLERANCES. SEPARATE POSITION CALLOUTS MAY BE GAGED
SEPARATELY REGARDLESS OF DATUM REFERENCES.

GEOMETRIC TOLERANCING SYMBOLS

☐ FLAT ☐ ROUNDT ☐ TOTAL ROUNDT ☐ ROUND
☐ ANGULAR ☐ STRAIGHT ☐ TRUE POSITION ☐ CYLINDRICAL
☐ CONCENTRIC ☐ PERPENDICULAR ☐ DIAMETER ☐ PARALLEL
☐ MAXIMUM MATERIAL CONDITION (MMC)
☐ LEAST MATERIAL CONDITION (LMC)
☐ PROJECTED TOLERANCE ZONE
☐ REGARDLESS OF FEATURE SIZE (RFS)

☐ PROFILE OF A LINE
☐ PROFILE OF A SURFACE
☐ DATUM IDENTIFICATION
☒ BASIC DIMENSION ☐ DATUM TARGET

OR

CK

SUP

WELD

MATERIAL

PROJ

DATE

A.S.F.

PART NAME

DESCRIPTION

FIRST USED ON

MOD ENGR

ENGR

PROJ

PIN

PART NO

8333178

SHEET 1 OF 1

UG SOLID

User: dillard Node: AD002494 Job: 8333178-dwg_d

1

5

10

A

B